

MOTORIZED MOBILE HEIGHT AND TILT ADJUSTABLE MONITOR STAND, 28 CM OF VERTICAL TRAVEL

COLUMN SILVER ANODIZED, C-STYLE BASE



PRODUCT

Low model mobile motorized height & tilt adjustable monitor stand.

Small group learning activities require for flexible interactive solutions. The Conen Mounts height tilt & table adjustable monitor stands give schools the freedom to create a collaborative area wherever needed. The "SCETTACL" features a short column with 28 cm of height adjustment, making it the perfect solution for K-6 or special needs applications.

Product ships flat-packed. Cartons are courier shippable.

Accessories



Front shelf

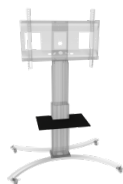

Front shelf



Front shelf



Front shelf



Lockable notebook cabinet



Side shelf for laptop

FEATURES

- Mobile adjustable monitor stand with motorized height and tilt adjustment
- Designed for K-6 applications
- 28 cm of smooth motorized height adjustment
- Tilt feature to position the display in any tilted position between 0 and 90 degrees
- Compatible with 65" - 75" flat panels with max. VESA 800x600
- Wired remote is standard included
- C-shaped mobile stand with 4 heavy duty castors, 2 lockable.



Display mount



Mobile



Table system



Motorized height adjustable



Single display



5 years warranty

Max. load
136 kg / 299.8 lbsMax. Vesa
800 x 600

Item number	SCETTA CL	
Vesa horizontal / Vesa vertical	400 mm - 800 mm / 200 mm - 600 mm	
Frame for all	42" - 70"	
Center to floor distance	634 mm - 914 mm	25" - 36"
Load capacity	136 kg	299.8 lbs
Width / Height / Depth	1340 mm / 926 mm - 1206 mm / 794 mm	52.8" / 36.5" - 47.5" / 31.3"
Warranty	5 years limited warranty	
Frame color	RAL 9005 deep black	
Column color	Silver anodized	
Base color	RAL 9006 white aluminum	
Packages	Package dimensions WxHxD	Package weight
AF-SCETTA	890 x 770 x 480 mm / 35 x 30.3 x 18.9"	26,8 kg / 59.1 lbs
CCET-28	680 x 270 x 220 mm / 26.8 x 10.6 x 8.7"	18 kg / 39.7 lbs
MST-SCETTA-C	1350 x 120 x 780 mm / 53.1 x 4.7 x 30.7"	15,5 kg / 34.2 lbs
Total weight	60,3 kg / 133 lbs	

DIMENSIONS

in mm / inch

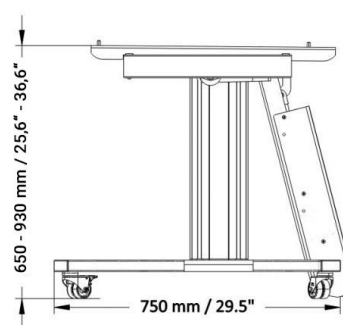
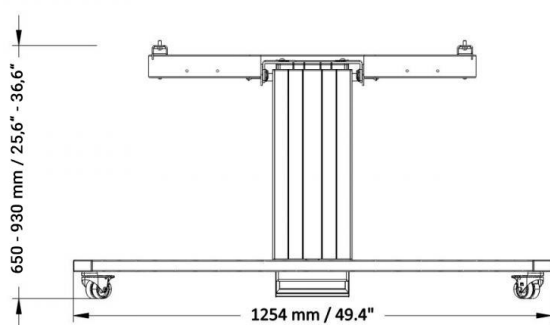
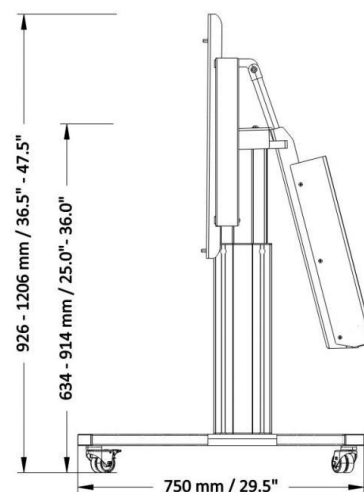
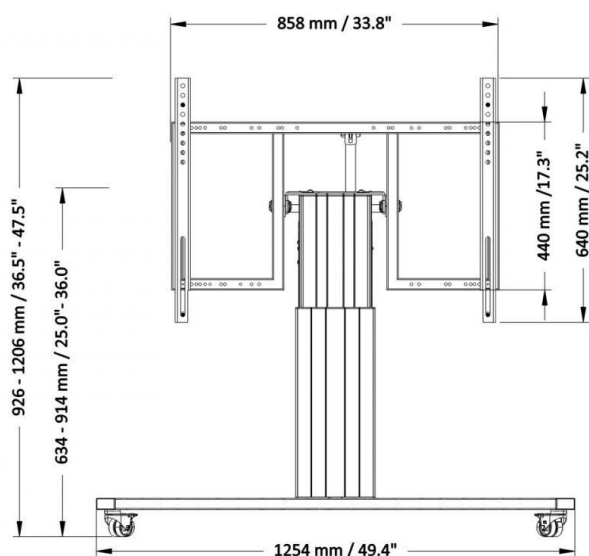

MANUFACTURER:

CONEN Produkte GmbH
Conenstr. 4
54497 Morbach-Gonzerath

Phone: +49 (0) 6533 75-100
Fax: +49 (0) 6533 75-600
E-Mail: info@conenmounts.com

Germany

www.conenmounts.com

03/06/2024
Page 2/2

CONEN

CONEN is not responsible for printing errors. CONEN reserves the right to change or modify pricing and product specifications with or without prior notification. Illustrations may not be exactly as shown. No parts may be reproduced by any means without prior authorization of CONEN. All rights reserved 2024.